

# Módulo Simples 1 Porta

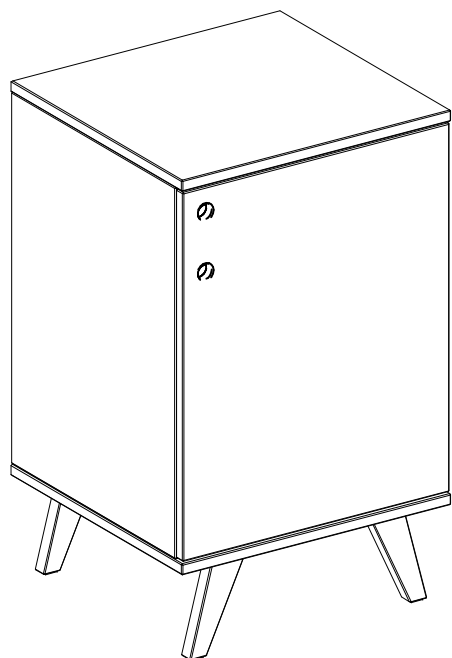

## PARTES DO PRODUTO:

1. Tampo
2. Lateral Direita
3. Lateral Esquerda
4. Base
5. Prateleira
6. Pé
7. Porta
8. Fundo

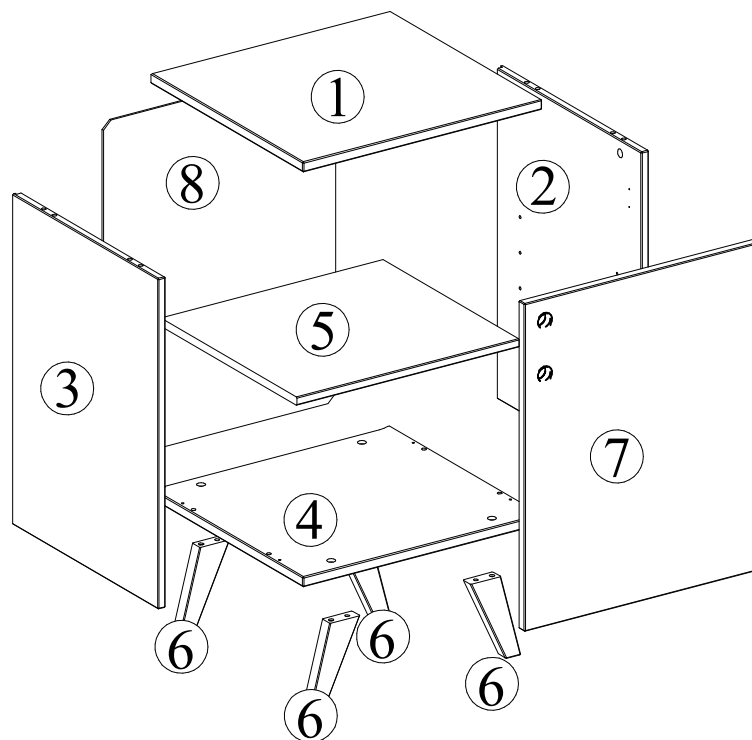

## ATENÇÃO:

1. Leia atentamente toda instrução antes de iniciar a montagem.
2. A montagem do produto deverá ser feita em uma superfície limpa e plana. Aconselhamos utilizar a própria embalagem para forrar o chão a fim de não danificar o produto.
3. Reservar área livre para montagem do produto.
4. Evitar batidas e o contato com objetos cortantes.
5. Para a limpeza do produto, utilize um pano levemente umedecido com água, seguido de um pano seco.

## VOCÊ PRECISARÁ DE:



1 hora



martelo



chave philips



Chave de Fenda

## FERRAGEM:

A-Cavilha 8x30 (12X)

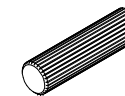

B-Parafuso Estrutural 7x50 (4x)

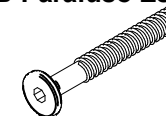

C-Chave Z (1x)



D-Feltro Adesivo (4x)

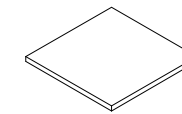

E-Tapa Furo (4x)

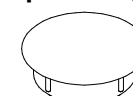

F-Parafuso 3,5x35 (4x)

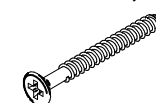

G-Tambor Minifix (4x)

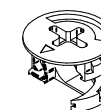

H-Parafuso Minifix (4x)

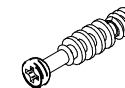

I-Prego (32x)



J-Dobradiça (2x)

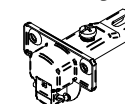

K-Calço (2x)

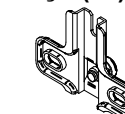

L-Parafuso 3,5x14 (4x)



M-Parafuso 3,5x12 (4x)

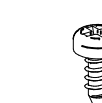

N-Pino Fixador (4x)

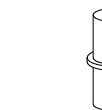

PASSO 01:

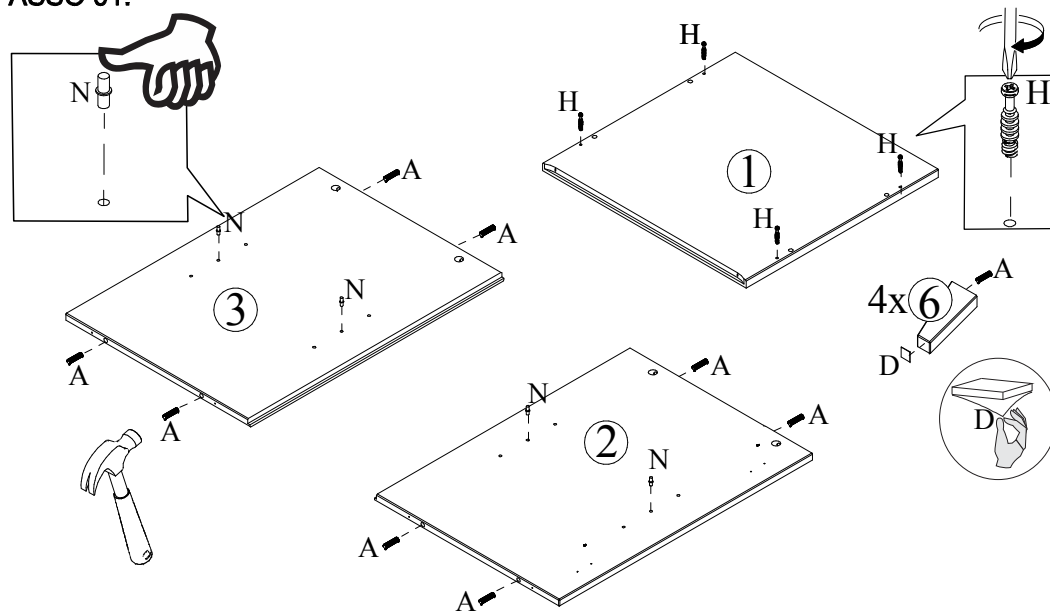

PASSO 03:

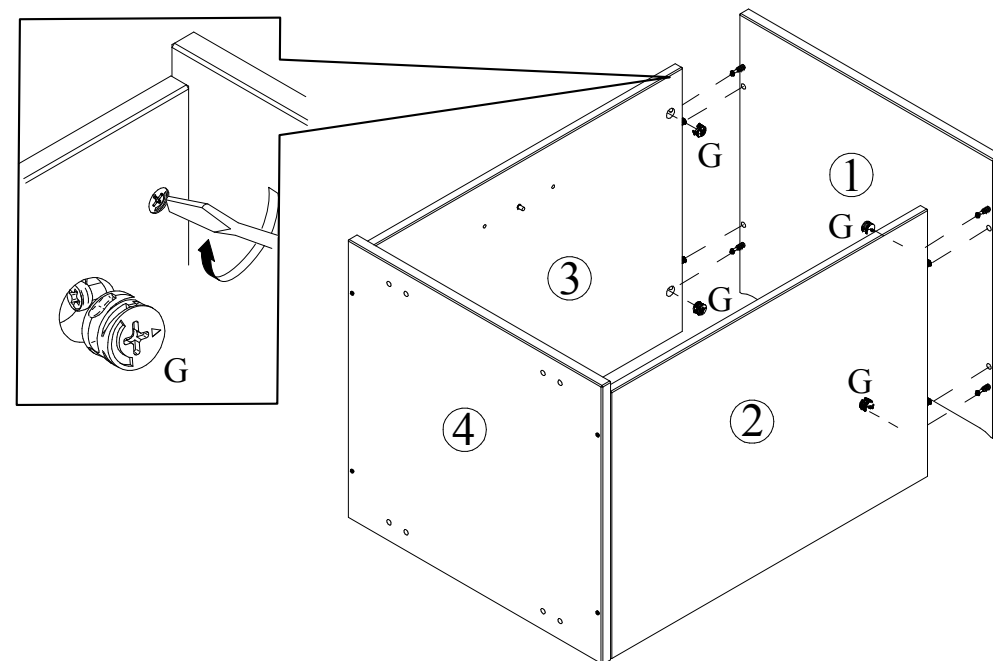

PASSO 02:

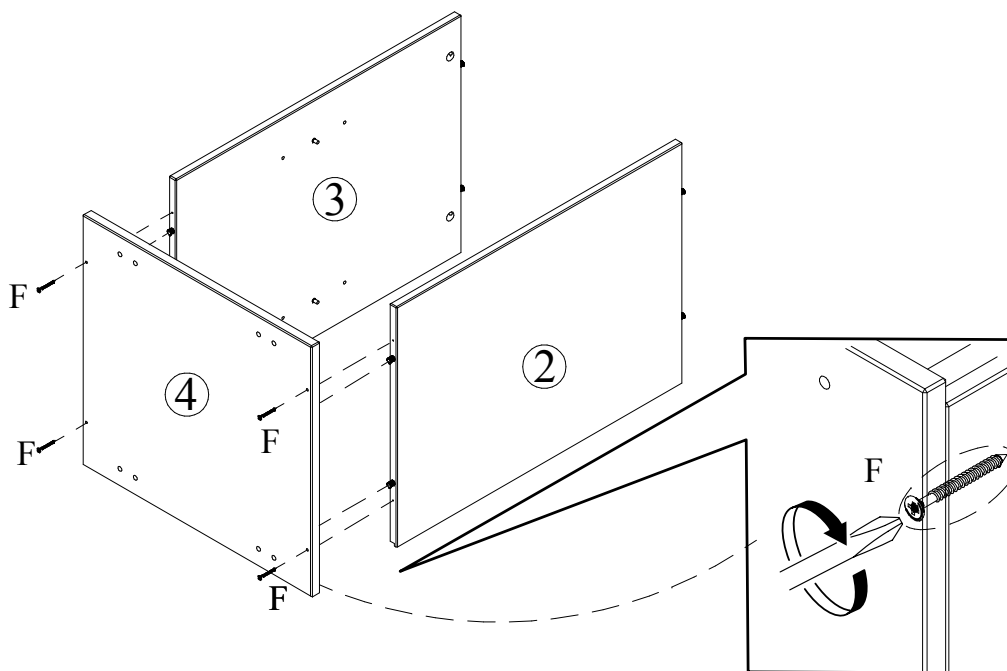

PASSO 04:

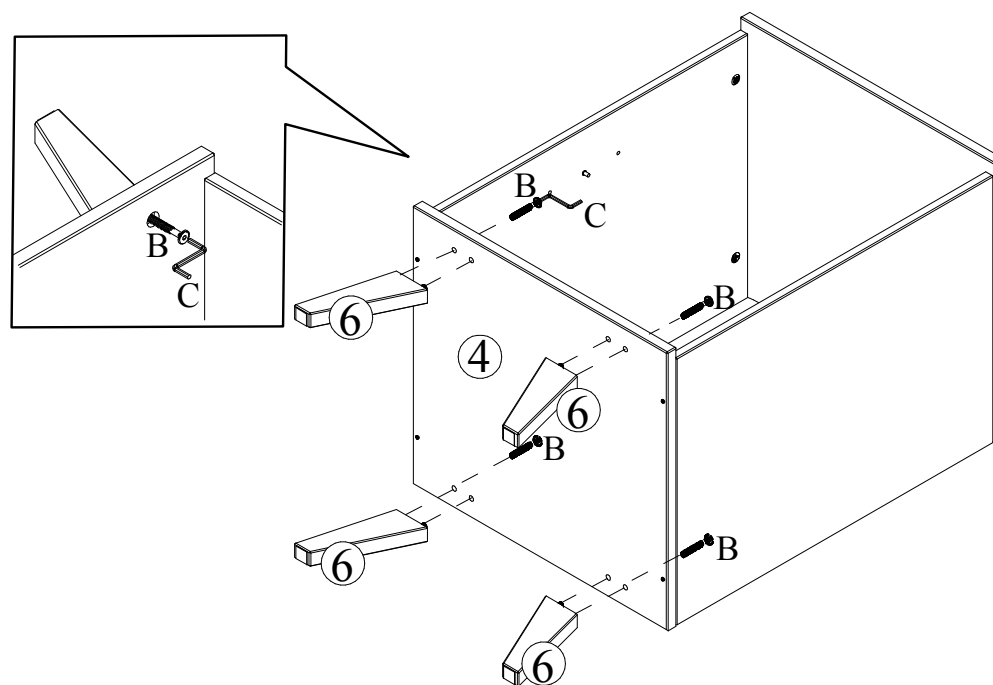

PASSO 05:

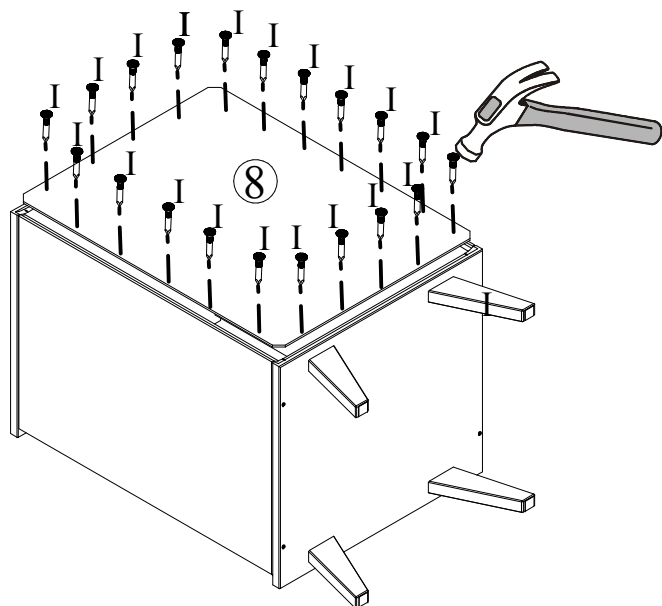

PASSO 06:

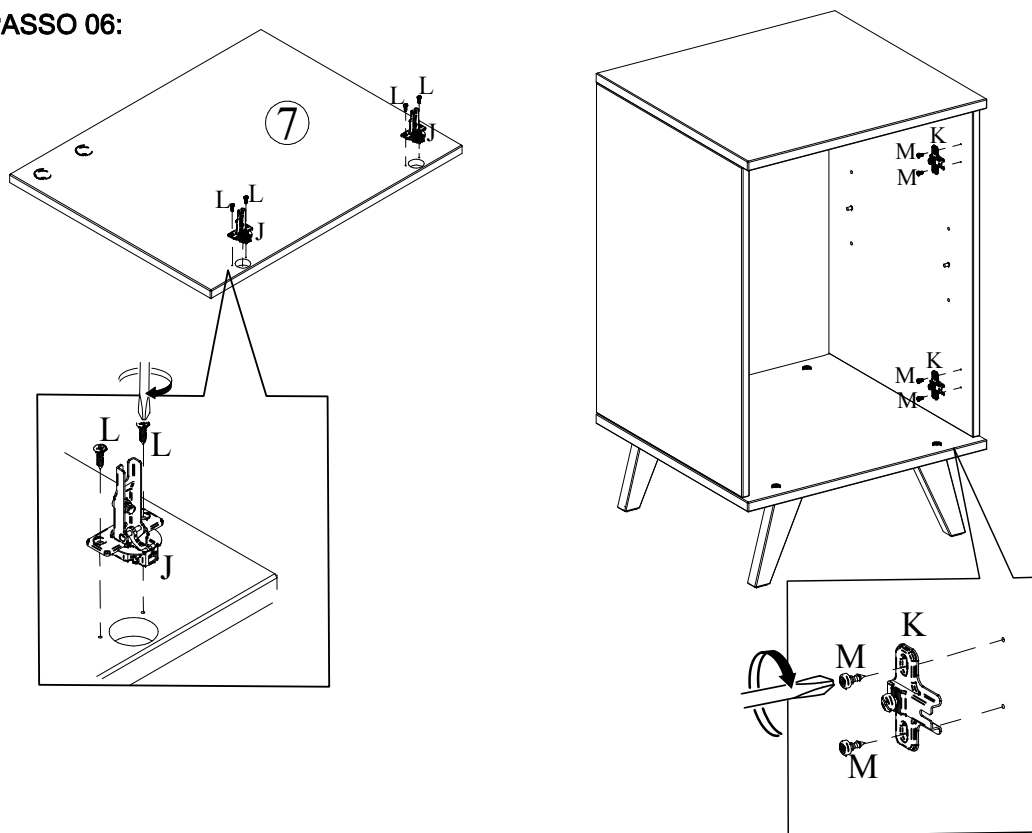

PASSO 07:

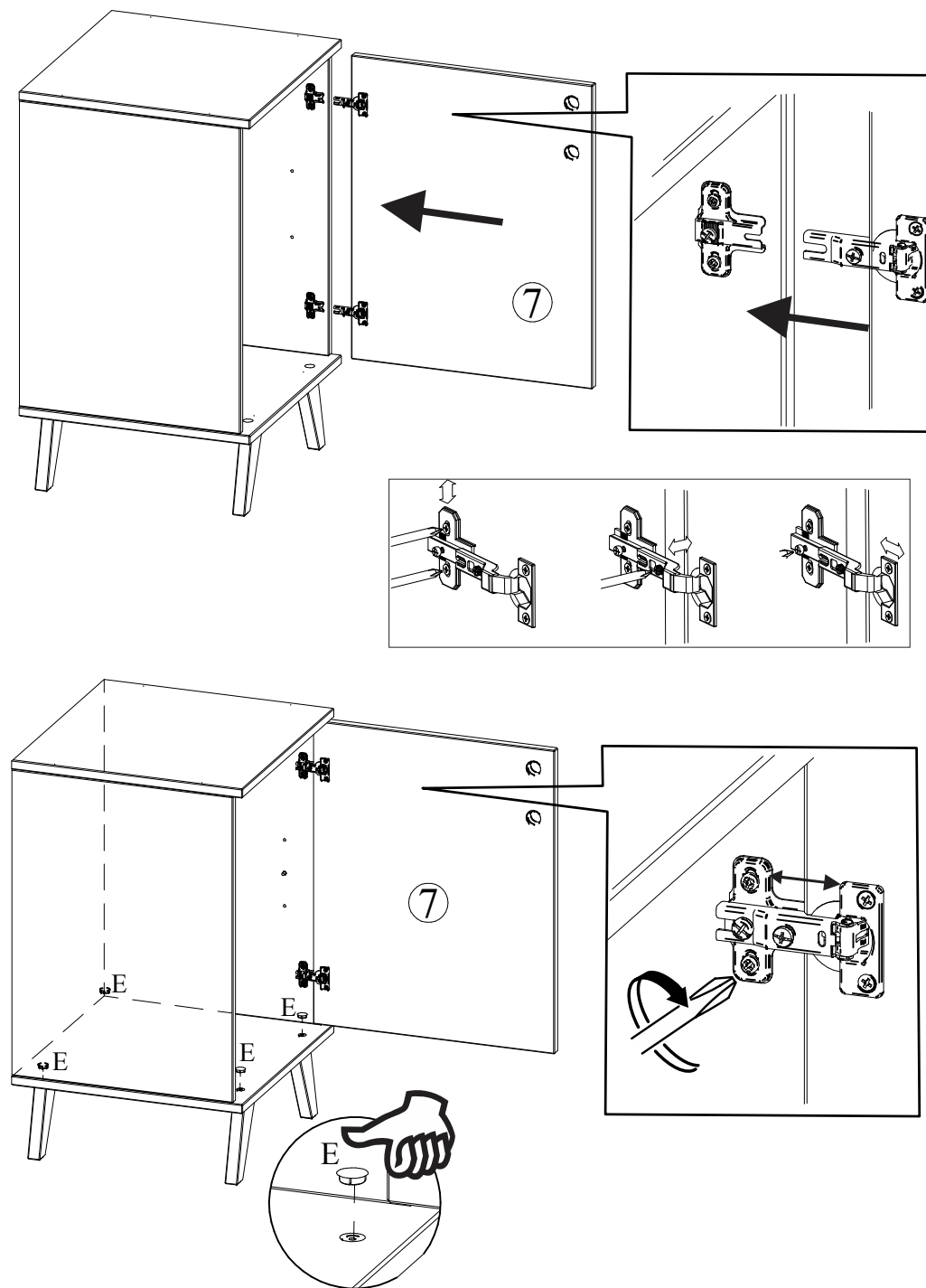

PASSO 08:

